

SILVERSTAR

COMMUNICATIONS

RECEIVED
2013 MAY 14 AM 9:48
IDAHO PUBLIC
UTILITIES COMMISSION

May 13, 2013

VIA E-Mail

Jean Jewell, Secretary
Idaho Public Utilities Commission
Boise, ID

Re: SIL-T-13-01, In the matter of the Petition of Silver Star Telephone Company, Inc. for Amendment of its Certificated Service Area Boundary

Dear Jean:

With this letter are enclosed revised service area boundary illustrations and descriptions for the service areas referenced in the above docket filing. These revised service area boundary illustrations are filed pursuant to discussions with Commission Staff and represent the final, adjusted boundaries for the referenced certificated service areas.

“Word” version descriptions of the revised boundaries will follow on CD via express delivery.

Please contact me you have questions or if I can be of further assistance.

Sincerely,

Michelle Motzkus

Michelle Motzkus
Legal & Regulatory Administrator
307-883-6690
mamotzkus@silverstar.net
PO Box 226
Freedom, WY 83120

SIL-T-13-01

In the matter of the Petition of Silver Star Telephone Company, Inc. for
Amendment of its Certificated Service Area Boundary

Revised Service Area Boundary Illustrations and Legal Descriptions

Wayan, ID Service Area (“Exchange”)

Irwin, ID Service Area (“Exchange”)

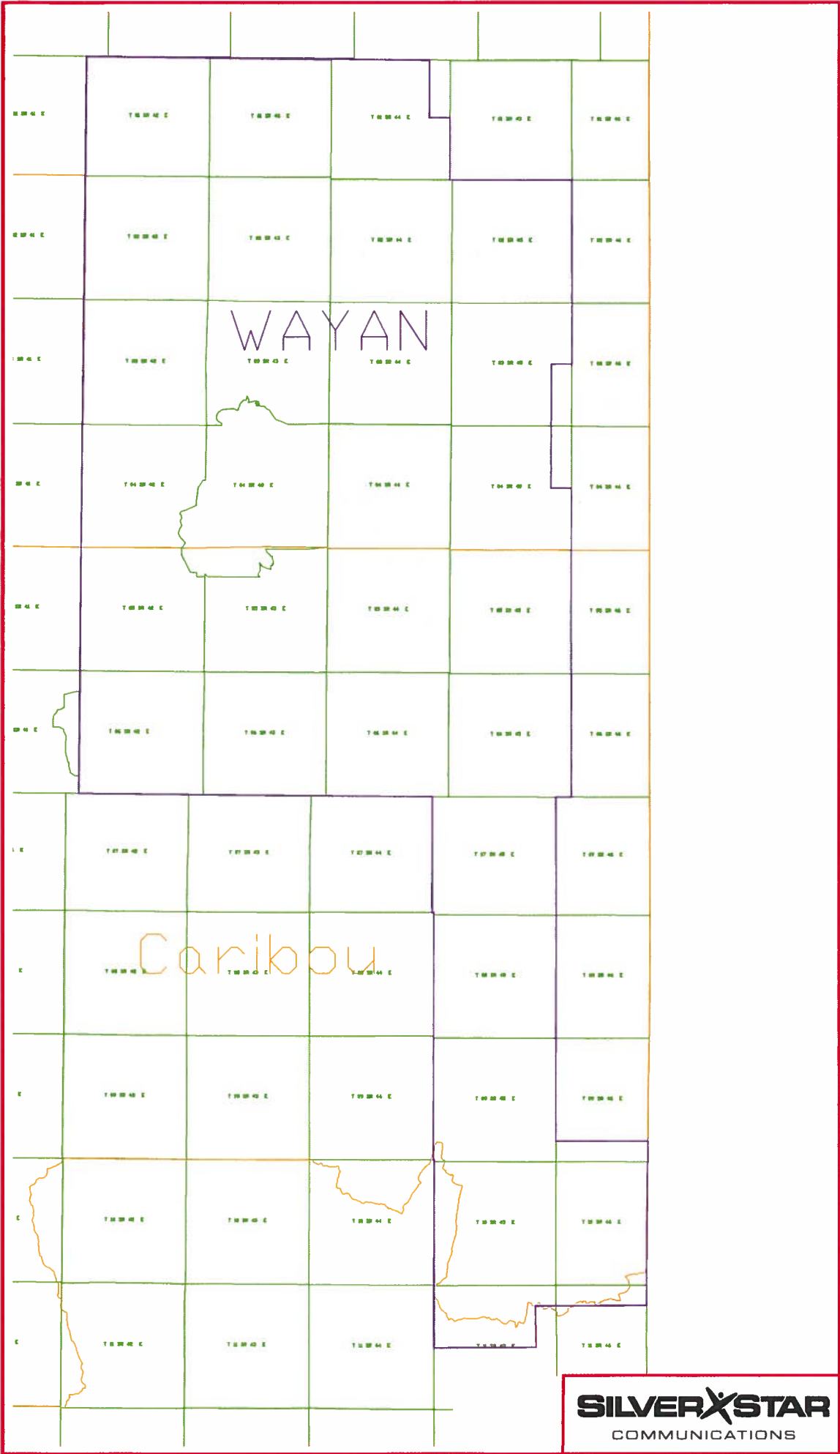

WAYAN EXCHANGE

Beginning at the NE corner of Section 1, T2S, R45E, thence west to the SE corner of Section 36, T1S, R44E, thence north to the NE corner of Section 24, T1S, R44E, thence west to the NE corner of Section 23, T1S, R42E, thence north to the NE corner of Section 2, T1S, R44E, thence west to the NW corner of Section 6, T1S, R42E, thence south to the SW corner of Section 31, T6S, R42E, thence east along the township line between T6S and T7S to the intersection of the range line between R44E and R45E, thence south along said range line to the SW corner of Section 18, T11S, R45E, thence east to the SE corner of Section 14, T11S, R45E, thence north to the NE corner of Section 11, T11S, R45E, thence east to the SW corner of Section 2, T11S, R46E, thence north to the NE corner of Section 35, T9S, R46E, thence west to the SW corner of Section 30, T9S, R46E, thence north to the NE corner of Section 1, T7S, R45E, thence east to the SW corner of Section 36, T6S, R45E, thence north to the NE corner of Section 24, T4S, R45E, thence west to the NE corner of section 23, T4S, R45E, thence north to the NE corner of Section 23, T3S, R45E, thence east to the SE corner of Section 13, T3S, R45E, thence north to the NE corner of Section 1, T2S, R45E and Point of Beginning.

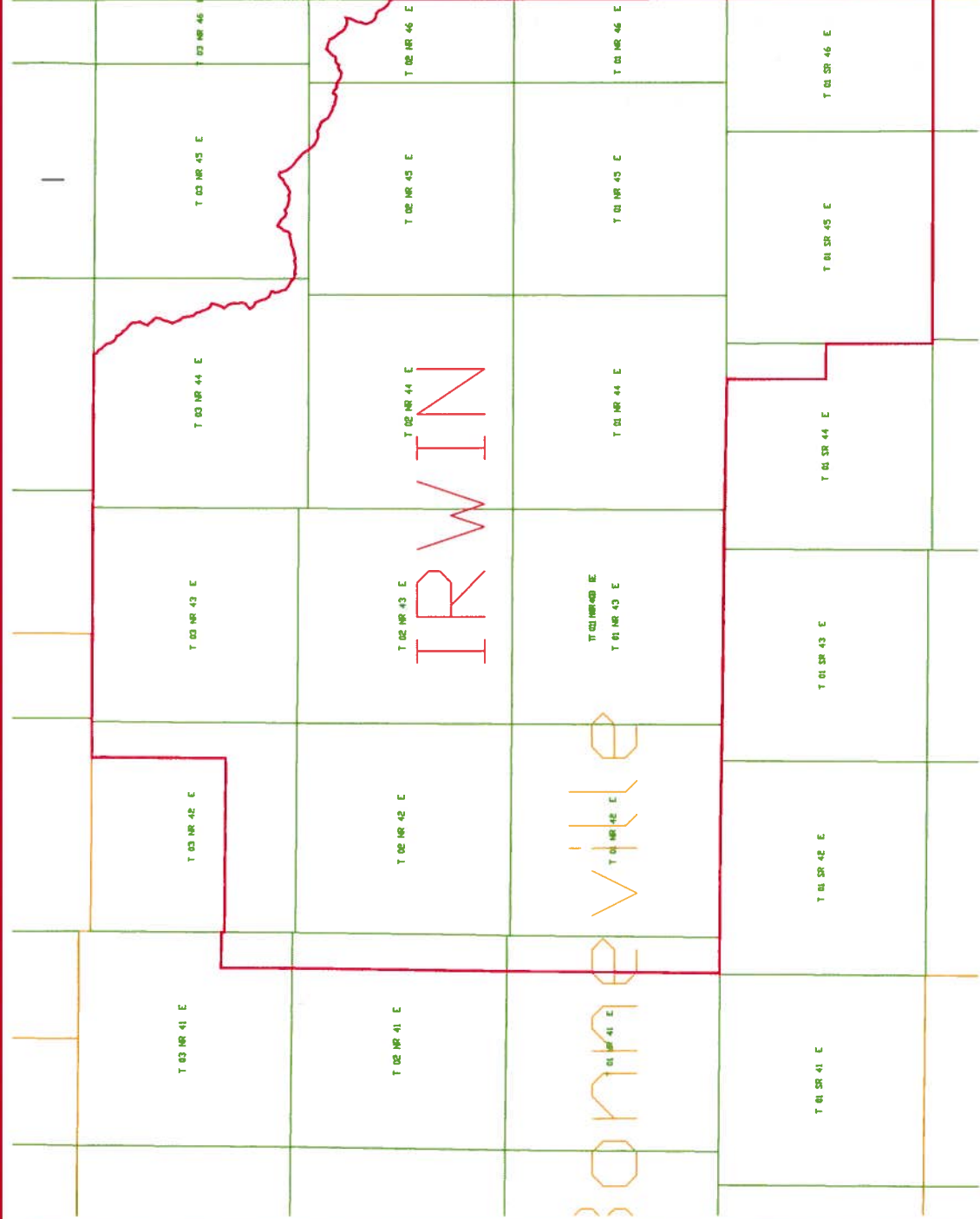

IRWIN EXCHANGE

Beginning at the SE corner of Section 34, T1S, R46E, thence west to the SW corner of Section 31, T1S, R45E, thence north to the NE corner of Section 24, T1S, R44E, thence west to the NE corner of Section 23, T1S, R44E, thence north to the NW corner of Section 1, T1S, R44E, thence west to the SW corner of Section 36, T1N, R41E, thence north to the NW corner of Section 25, T3N, R41E, thence east to the NE corner of Section 25, T3N, R41E, thence south to the NW corner of Section 30, T3N, R42E, thence east to the NW corner of Section 25, T3N, R42E, thence north to the NW corner of Section 1, T3N, R42E, thence east along the township line between Townships 3N and 4N to a point where the said line bisects the top or comb of the Big Hole Mountain Range, thence following along the top or comb of the said mountains in a southeasterly direction to the west line of the State of Wyoming, thence south along said west line of the State of Wyoming to the SE corner of Section 34, T1S, R46E and Point of Beginning.